

SIMPO Cabinets are pre-wired for easy connection. Designed to maximize and expand system power through easy parallel connection.

 Paralleled Cabinets  Maximize Power

 Pre-wired  Easy Connection



SIMPO Cabinet6

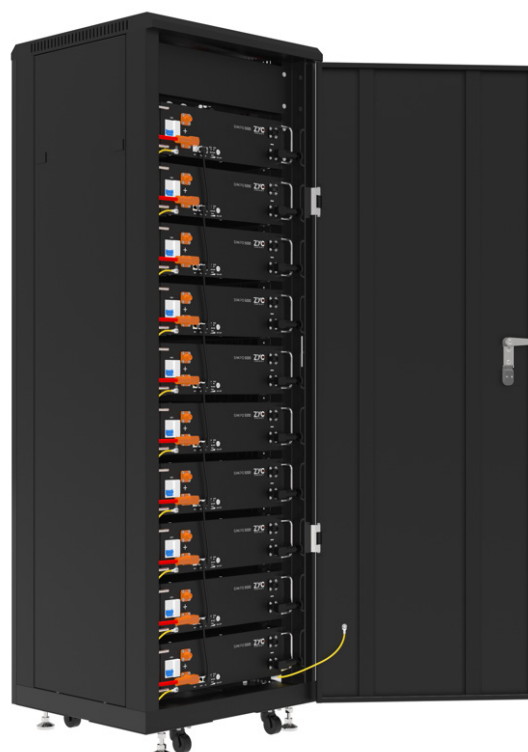

SIMPO Cabinet10

General Data	SIMPO Cabinet6	SIMPO Cabinet10
Dimension (W x D x H)	620 x 600 x 1270mm	620 x 600 x 1890mm
Base	4 wheels for easy moving and 4 feet for load-bearing	
Max. Qty of Modules	6 (30.72kWh)	10 (51.2kWh)
Max Continuous Current (busbar)	600A (with M10 Nut Bolting)	1000A (with M12 Nut Bolting)
Battery Interconnection	Pre-wired Quick Connector with 4AWG UL Cable	
DC Circuit Breaker	None	
Cable Entry	Top Entry	
IP Rating	IP20	IP20
Weight	90kg	120kg

SIMPO Cabinet6 Wiring

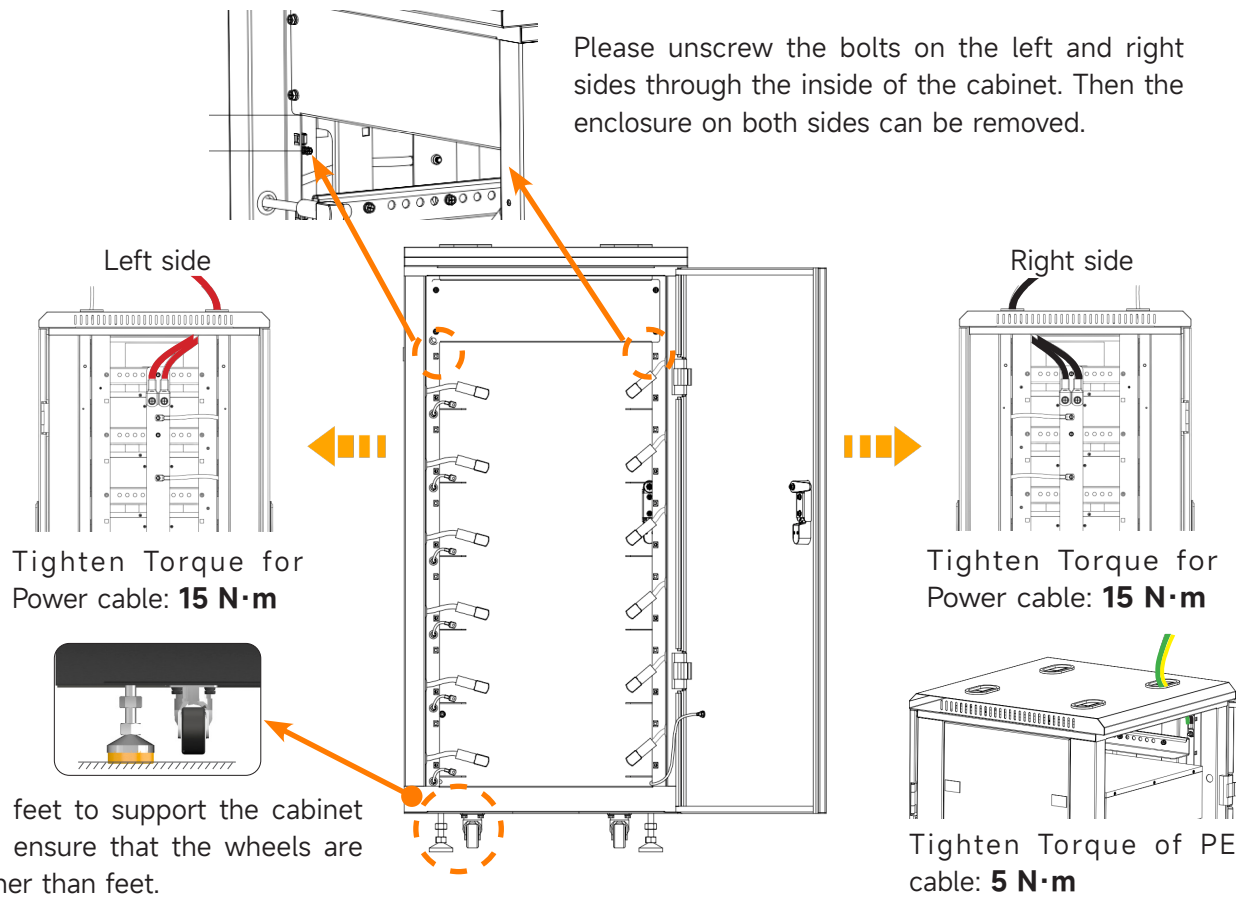

SIMPO Cabinet10 Wiring

Please remove the front top panel, and unscrew the bolts on the left and right sides through the inside of the cabinet. Then the enclosure on both sides can be removed.

